



Fumagalli S.p.A

Milano - Roma - Italy

V A L V E S

**ANSI Globe Valves
Class 150**

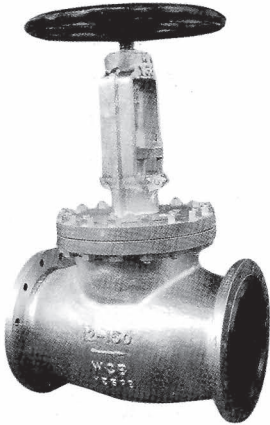

APPLICABLE STANDARD

Basic Design: BS1873

Face To Face / End To End: ANSI B16.10;

End Flanges:

2"–24": ANSI B16.5

Welding Ends: ANSI B16.25

Shell Wall Thickness:

2"–24": API600

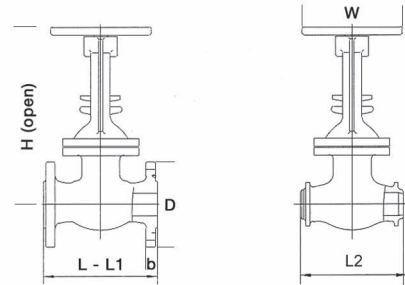

DIMENSIONS AND WEIGHTS

* Gear Operated

NOM SIZE	L/L2		L1		D		b		H Open		W	Wt Kgs
	RF/BW		RTJ									
	IN	MM	IN	MM	IN	MM	IN	MM	IN	MM	MM	
2	8.00	203	8.50	216	6.00	152.4	0.62	16	16.12	410	200	22
2½	8.50	216	9.00	229	7.00	177.8	0.69	18	17.00	432	200	30
3	9.50	241	10.0	254	7.50	190.5	0.75	19	17.68	450	250	42
4	11.5	292	12.0	305	9.00	228.6	0.94	24	19.68	500	250	60
5	14.0	356	14.5	368	10.0	254.0	0.94	24	21.19	538	300	77
6	16.0	406	16.5	419	11.0	279.4	1.00	25	21.62	550	350	101
8	19.5	495	20.0	508	13.5	342.9	1.12	28	24.43	620	400	161
10	24.5	622	25.0	635	16.0	406.4	1.19	30	30.00	762	750	308
12	27.5	698	28.0	711	19.0	482.6	1.25	32	33.88	860	750	410
14*	31.0	787	31.50	800	21.0	533.4	1.38	35	56.00	1442	GO	610
16*	36.0	914	36.50	927	23.5	596.9	1.44	37	64.00	1625	GO	880
18*	38.5	977	38.98	990	25.0	635.0	1.56	40	71.18	1820	GO	1150
20*	38.5	977	38.98	990	27.5	698.5	1.69	43	79.64	2023	GO	1650
24*	51.0	1295	51.50	1308	32.0	812.8	1.88	48	87.72	2228	GO	2200



Fumagalli S.p.A
Milano - Roma - Italy

ANSI Globe Valves
Class 150

V A L V E S

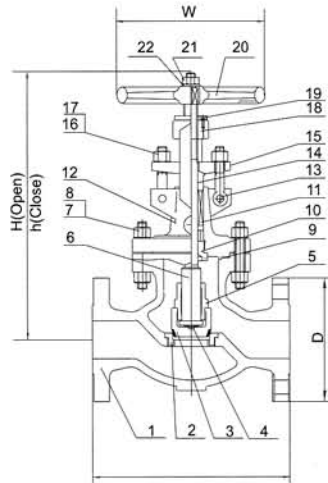

BILL OF MATERIALS & PARTS

Part No.	Part Name	ASTM Specifications (Specs. – Grades/Types)				
		A216	A352	A217		A351
		WCB	LCC	WC6	C5	CF8M
1	Body	A216-WCB	A352-LCC	A217-WC6	A217-C5	A351-CF8M
2	Seat Ring	A105 ,LF2, 316 OR 304				
	Seat Ring Surface	13CR, HF(STELLITE), 316, 304, Monel				
3	Disc	A216-WCB	A352-LCC	A217-WC6	A217-C5	A351-CF8M
	Disc Sealing Surface	13CR, HF(STELLITE), 316, 304, Monel				
4	Disc Trust Plate	13Cr ,316 OR 304				
5	Disc Nut	13Cr , 316 OR 304				
6	Stem	13CR , 316 OR 304, 17-4PH, Monel				
7	Bonnet Bolt Nut	A194-2H	A194-4	A194-2H	A194-4	A194-8
8	Bonnet Bolt	A193-B7	A320-L7	A193-B7	A193-B16	A193-B8
9	Gasket	Soft Iron, Spiral Wound				
10	Bonnet Bushing	13Cr ,316 OR 304				
11	Gland Packing	Braided Graphite & Die Formed Graphite Ring				
12	Bonnet	A216-WCB	A352-LCC	A217-WC6	A217-C5	A351-CF8M
13	Eye Bolt Pins	13Cr ,316 OR 304				
14	Gland	13Cr ,316 OR 304				
15	Gland Flange	A216-WCB	A352-LCC	A217-WC6	A217-C5	A351-CF8M
16	Gland Eye Bolts	A193-B7	A320-L7	193-B16		A193-B8
17	Eye Bolt Nuts	A194-2H	A194-7M	A194-2H		A194-8
18	Yoke Sleeve	ASTM A439 GR D2C				
19	Screw	Carbon Steel				316
20	Handwheel	Malleable Iron				
21	Handwheel Nut	Carbon Steel				316
22	Backing Ring	Carbon Steel				316