



Fumagalli S.p.A

Milano - Roma - Italy

V A L V E S

ANSI Swing Check Valves
Class 900

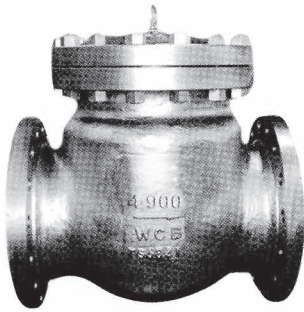

APPLICABLE STANDARD

Basic Design: BS1868,API6D

Face To Face / End To End: ANSI B16.10;

End Flanges:

2"–16": ANSI B16.5

Welding Ends: ANSI B16.25

Shell Wall Thickness:

2"–16": API600

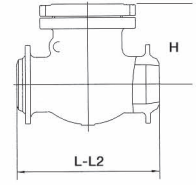
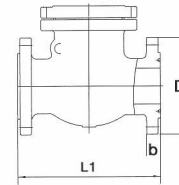

DIMENSIONS AND WEIGHTS

NOM SIZE	L/L2		L1		D		b		H		Wt Kgs
	RF/BW		RTJ								
	IN	MM	IN	MM	IN	MM	IN	MM	IN	MM	
2	14.5	368	14.63	371	8.50	215.9	1.50	38.1	9.88	250	69
2½	16.5	419	16.63	422	9.63	244.5	1.63	41.3	10.6	270	93
3	15.0	381	15.13	384	9.50	241.3	1.50	38.1	9.13	230	85
4	18.0	457	18.13	460	11.50	292.1	1.75	44.4	12.3	310	145
6	24.0	610	24.13	613	15.00	381.0	2.19	55.6	14.3	360	310
8	29.0	737	29.13	740	18.50	469.9	2.50	63.5	17.0	430	500
10	33.0	838	33.13	841	21.50	546.1	2.75	69.8	18.9	480	772
12	38.0	965	38.13	968	24.00	609.6	3.12	79.4	22.0	560	1080
14	40.5	1029	40.88	1038	25.25	641.2	3.38	85.7	24.8	629	1500
16	44.5	1130	44.88	1140	27.75	704.8	3.50	88.9	27.6	700	2130



Fumagalli S.p.A

Milano - Roma - Italy

ANSI Swing Check Valves
Class 900

V A L V E S

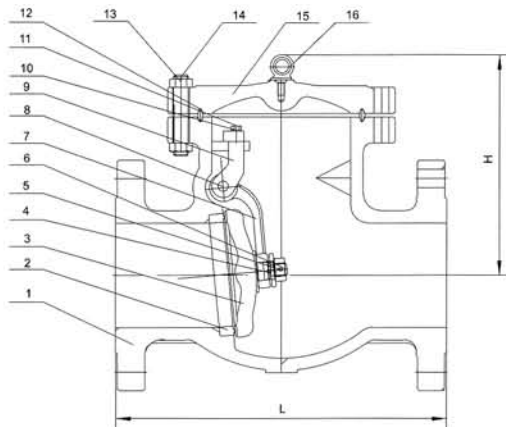

BILL OF MATERIALS & PARTS

Part NO.	Part Name	ASTM Specifications (Specs. – Grades/Types)				
		A216	A352	A217		A351
		WCB	LCC	WC6	C5	CF8M
1	Body	A216-WCB	A352-LCC	A217-WC6	A217-C5	A351-CF8M
2	Seat Ring	A105 , 316 OR 304				
	Seat Ring Surface	13Cr , HF(STELLITE), 316 OR 304				
3	Disc	A216-WCB	A352-LCC	A217-WC6	A217-C5	A351-CF8M
	Disc Sealing Surface	13Cr , HF(STELLITE), 316 OR 304				
4	Washer	13Cr , 316 OR 304				
5	Pin	13Cr , 316 OR 304				
6	Disc Nut	13Cr , 316 OR 304				
7	Hinge	A216-WCB	A352-LCC	A217-WC6	A217-C5	A351-CF8M
8	Hinge Pin	Stainless Steel				
9	Bearing Bracket	A216-WCB	A352-LCC	A217-WC6	A217-C5	A351-CF8M
10	Spring Washer	Stainless Steel				
11	Hex, Bolt	Stainless Steel				
12	Gasket	Ring Joint-Iron				
13	Cover Bolt	A193-B7	A320-L7M	A193-B7/A193-B16		A193-B8
14	Cover Bolt Nut	A194-2H	A194-7M	A194-4		A194-8
15	Cover	A216-WCB	A352-LCC	A217-WC6	A217-C5	A351-CF8M
16	Eye Bolt	A181				